

# Foster Arend Park - Site Plan



4051 East River Road NE



## Amenities

- A) Shelter
- B) Bathhouse & Restroom
- C) Playground
- D) Horseshoes
- E) Volleyball
- F) Beach
- G) Fishing Pier
- H) Parking for 217 cars

## Electrical

**DO NOT OVERLOAD CIRCUITS!!!**

Figure out the amps required for each appliance with the following formula:

$$\text{Amps(A)} = \frac{\text{Watts(W or VA)}}{\text{Volts(V)}}$$

Sometimes the amps may be listed on the appliance. Add together the amps from individual appliances in such a way to stay below the maximum limit per circuit. To be safe, stay 3-4 amps below the maximum, meaning 16-17 amps for a 20 amp circuit.

## Area Map



Foster Arend Park - 4051 East River Road NE

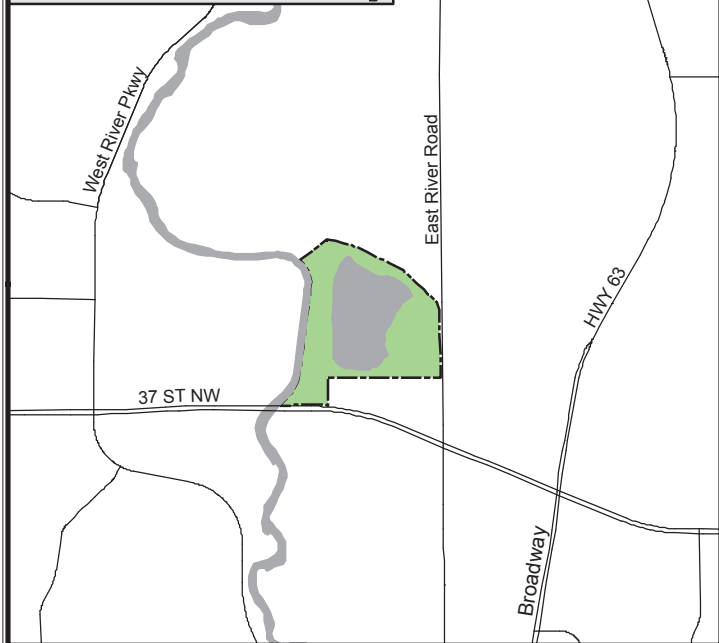

## Shelter Plan



Foster Arend Park - 4051 East River Road NE

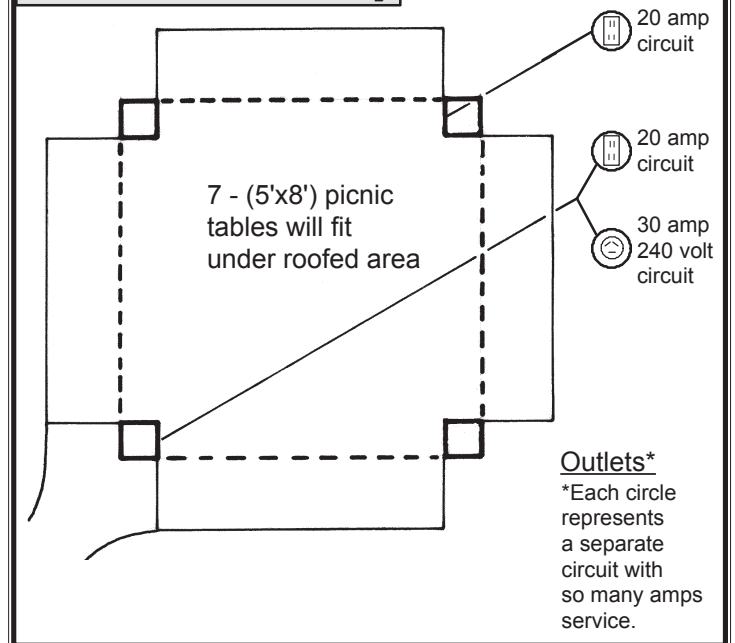

**Outlets\***  
\*Each circle represents a separate circuit with so many amps service.